

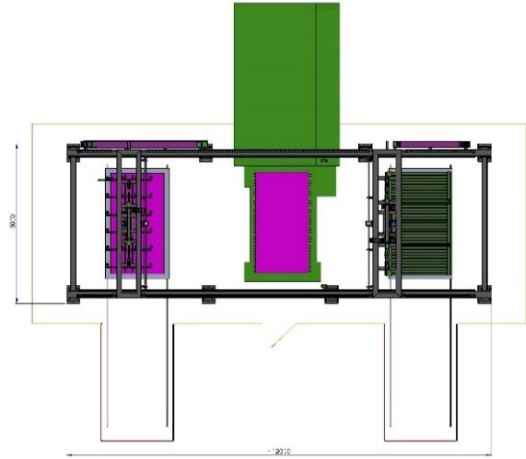

LOADING/UNLOADING CELL FOR LASER MACHINE
Art. CSLA-S
Maximum piece dimension: 1500 x 3000 mm
Maximum thickness: 5 mm

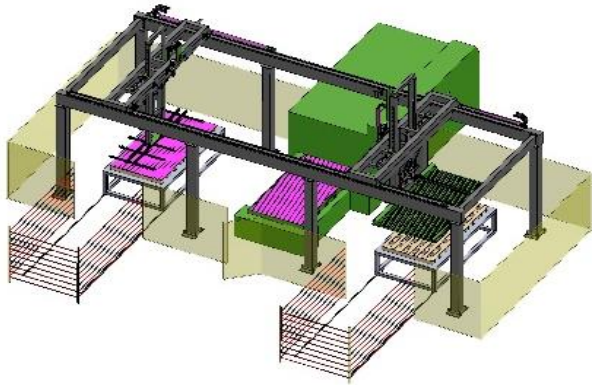

UNIT	UNIT DESCRIPTION	Q.TY	PRICE
00	Development of layout, system design	1	
10	Cartesian portal	1	
20	Vertical axis of the portal	2	
30	Fork without belt	1	
40	Gripper system for virgin sheet metal	1	
50	Fixed bench for loading and unloading	2	
100	Electric and pneumatic system	1	
110	Protections guards	1	
120	Installation of SISTEC sub-assemblies	1	
130	Trial and internal test at SISTEC	1	
SUB-TOTAL, EX-WORKS			€ 134,000.00
UNIT	OPTIONAL	Q.TY	PRICE
50	Motorized workbench for loading/unloading	2	€ 21,000.00
30	Difference for fork with belt	1	€ 13,000.00
UNIT	EXCLUSIONS		
00	Development of software for system management		
140	Installation, wiring and start-up		