



**LOADING/UNLOADING CELL FOR LASER MACHINE WITH SORTING**

**Art. CSLA-SORTING**

**Maximum piece dimension: 1500 x 3000 mm**

**Maximum thickness: 5 mm**

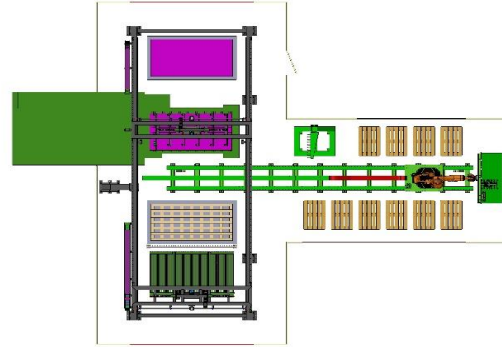
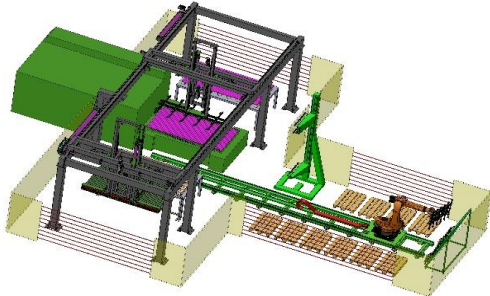

UNIT	UNIT DESCRIPTION	Q.TY	PRICE
00	Development of layout, system design	1	
10	Cartesian portal	1	
20	Vertical axis of the portal	2	
30	Fork without belt	1	
40	Gripper system for virgin sheet metal	1	
50	Fixed bench for loading and unloading	2	
100	Electric and pneumatic system	1	
110	Protections guards	1	
120	Installation of SISTEC sub-assemblies	1	
130	Trial and internal test at SISTEC	1	
<b>ROBOT SECTION</b>			
60	Robot 90 Kg, R=3100 mm, con 7° asse (L = 10 m)	1	
70	Gripper	3	
80	Gripper store (5 rooms)	1	
90	Sheet reverser	1	
00	Sorting software	1	

**SUB-TOTAL, EX-WORKS**

**€ 330,000.00**

UNIT	OPTIONAL	Q.TY	PRICE
50	Motorized workbench for loading/unloading	2	€ 21,000.00
30	Difference for fork with belt	1	€ 13,000.00

UNIT	EXCLUSIONS
00	Development of software for system management
140	Installation, wiring and start-up